

JVC

LT-Z26EX6
LT-Z32EX6
LT-Z37EX6

โทรทัศน์ที่มีจอ LCD แบบกว้าง
WIDE LCD PANEL TV

คู่มือการใช้งาน
INSTRUCTIONS

JVC



LT-Z26EX6

DynaPiX **HD**
Powered by D.L.S.E.

HDMI[™]
HIGH-DEFINITION MULTIMEDIA INTERFACE



LT-Z26EX6 / LT-Z32EX6

LT-Z37EX6

1

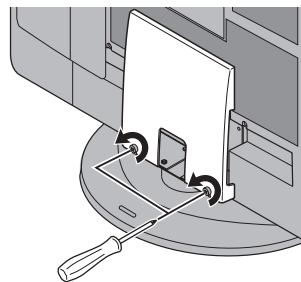
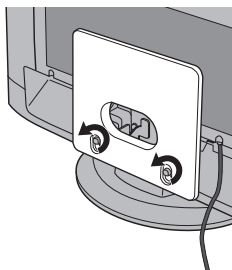

2

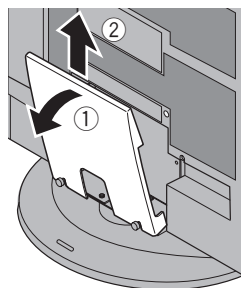
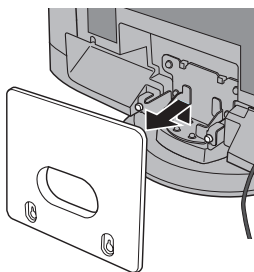

3

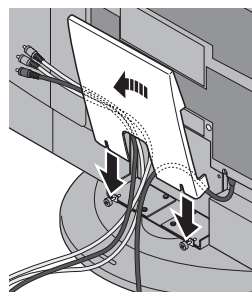
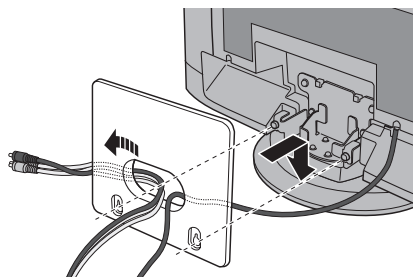

4

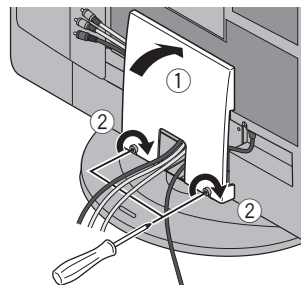
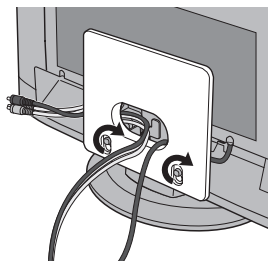

JVC

Expanding the world of beautiful images

ENGLISH

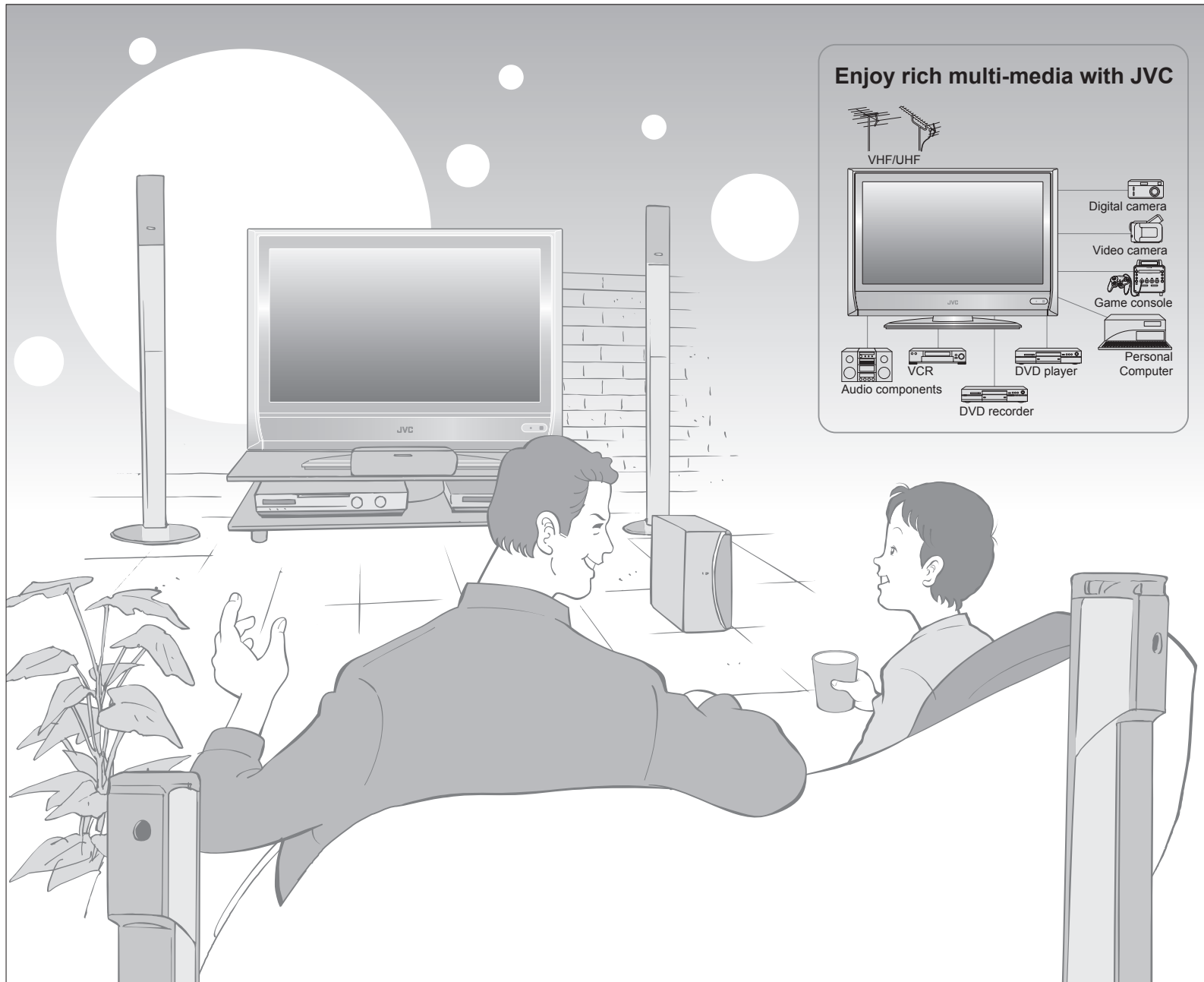

Enjoy rich multi-media with JVC

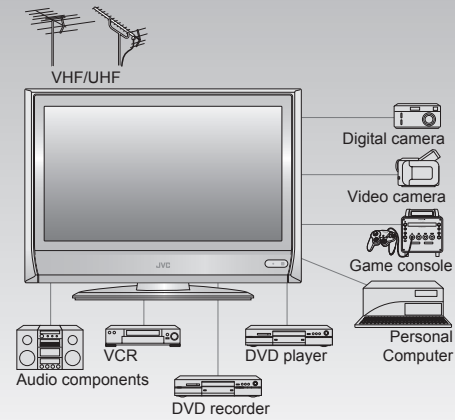

Contents

ENGLISH

First things first!

- Warning 3

Getting started

- Names of all the parts 5
- Basic connections 7
- Initial settings 9
- Editing channels 11
 - Registering channels
- Connecting external devices 13

Let's try it out

- Enjoying your new TV! 15
 - TV / Teletext / Video / etc.
- Watching TV 17
- Viewing teletext 19
- Watching videos / DVDs 21

Try the advanced features

- Useful functions 23
 - Take a snapshot
 - View and search in multi-picture mode
 - "Sleep Timer" / "Channel Guard"

Just the way you like it

- Customising your TV 27
- Advanced picture adjustment 29
 - Reduce noise / Watch a more natural picture
 - Set the aspect ratio, etc.

When you have trouble

- Troubleshooting 31
- Technical information 35
- "CH/CC" List 37
- Specifications 38

IMPORTANT!

PREPARE

USE

SETTINGS

TROUBLE?

Warning

Please follow all the guidelines below

ENGLISH

Follow this manual regarding setup!

- Connect only to a 110-240V, 50/60Hz AC outlet.

Make enough room for inserting and removing the power plug!

Place the TV as close to the outlet as possible!

- The main power supply for this TV is controlled by inserting or removing the power plug.

Never cut or damage the power cord!

- If the AC plug is not the right shape, or the power cord is not long enough, use an appropriate plug adapter or extension cable. (Consult your retailer.)

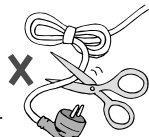

Unplug the power cord when going out!

- The power buttons on the remote control and the TV unit cannot completely turn off the TV. (Make appropriate arrangements for bedridden people.)

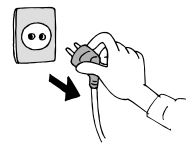

Do not allow the TV to fall!

- Do not rest your elbows on, or allow children to hang from the TV. There is a risk that the TV will fall and cause injuries.

Never try to repair the TV yourself!

→ If the problem cannot be solved in "Troubleshooting" (P. 31), unplug the power cord and contact your retailer.

When attaching the TV to the wall, use the optional JVC wall mounting unit!

- Consult a qualified technician.
- See the included manual on mounting procedures.
- JVC assumes no responsibility for damage due to improper mounting.

If the TV is damaged or behaving strangely, stop using it at once!

→ Unplug the power cord and contact your retailer.

Never place anything on the TV!

- Placing liquids, naked flames, cloths, paper, etc. on the TV may cause a fire.



Never expose to rain or moisture!

- To prevent fire or electric shock, never allow liquids to enter the unit.



Never insert objects into the cabinet openings!

- It may cause a fatal electric shock. Take care when children are near.



Never listen to headphones at high volume!

- It may damage your hearing.

Never dismantle the rear panel!

- It may cause an electric shock.

Never obstruct the ventilation holes!

- It may cause overheating or a fire.

Handle LCD panel with care!

- Use a soft, dry cloth when cleaning.

Hold the TV so as not to scratch the screen!

- Do not touch the screen when carrying the TV.

Do not carry the TV on your own!

- In order to prevent accidents, ensure that the TV is carried by two or more people.



ENGLISH

IMPORTANT!

PREPARE

USE

SETTINGS

TROUBLE?

■ For more details on installation, usage and safety → Consult your retailer

Names of all the parts

ENGLISH

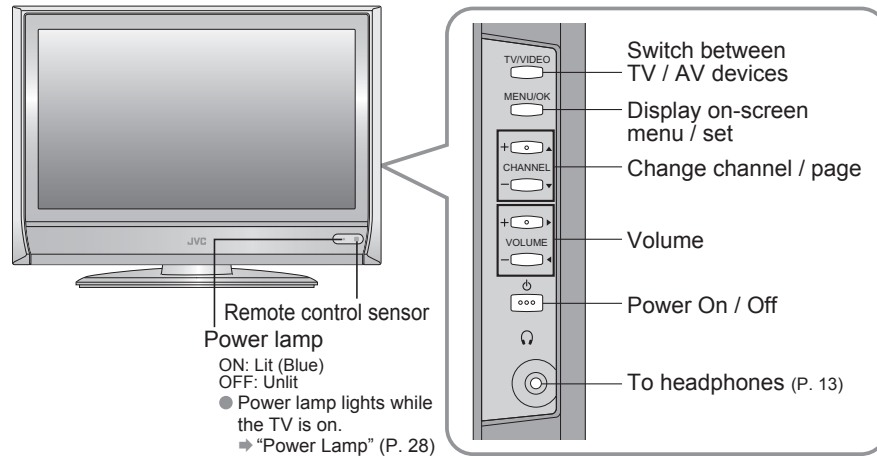

Remove the terminal cover

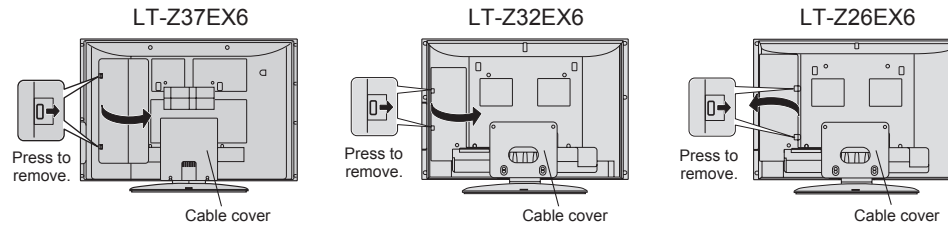

- If the cover cannot be closed due to the cables being in the way
➔ Do not force the cover to close (leave it open).
- Connecting terminals on the back of the TV ➔ Connecting External devices (P. 13)

Check accessories

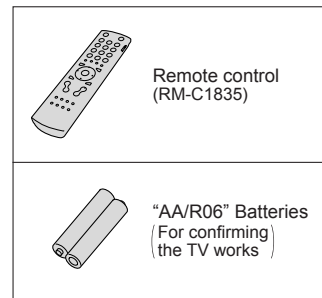

ENGLISH

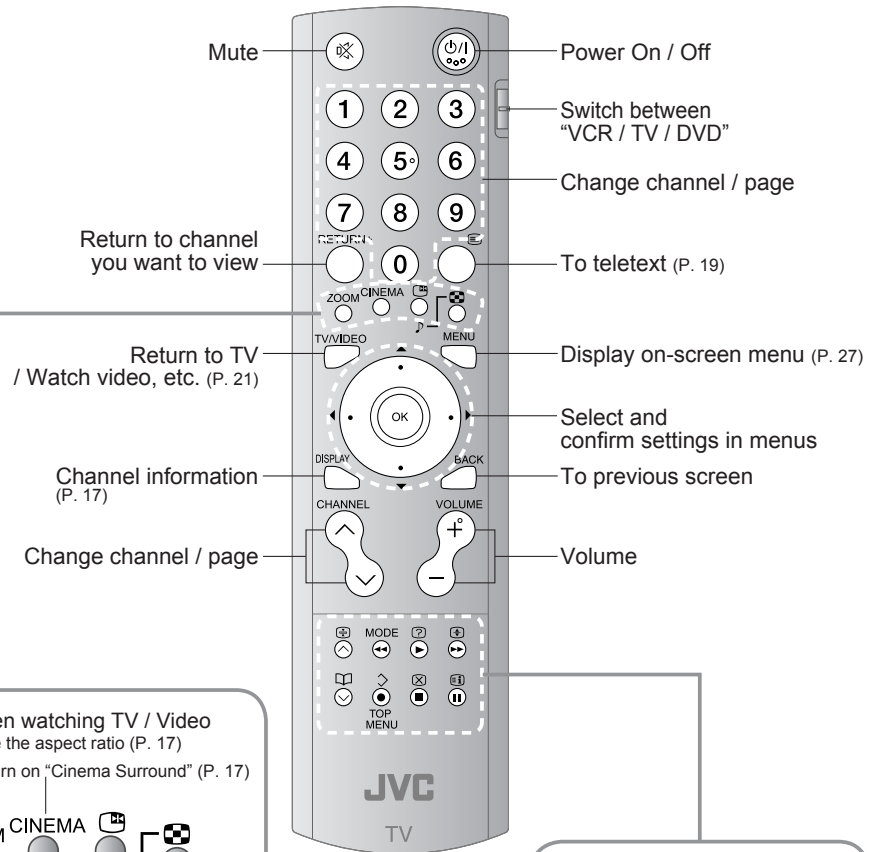

■ When watching TV / Video
Change the aspect ratio (P. 17)
Turn on "Cinema Surround" (P. 17)

Take a snapshot of the screen (P. 23)
View in multi-picture mode (P. 23)

■ Insert the batteries
Use two "AA/R06" dry cell batteries.
Insert the batteries from the ⊖ end, making sure the ⊕ and ⊖ polarities are correct.

■ When viewing teletext (P. 19)
Hold the current page
Bookmark pages
Reveal hidden pages
Enlarge the text

Switch briefly between teletext and TV
To index page

IMPORTANT!

PREPARE

USE

SETTINGS

TROUBLE?

Basic connections

Please read the user manuals of each device carefully before setup.
It is necessary to connect an aerial to watch TV.

■ Connect with other devices → "Connecting external devices" (P. 13)

ENGLISH

Connect the aerial

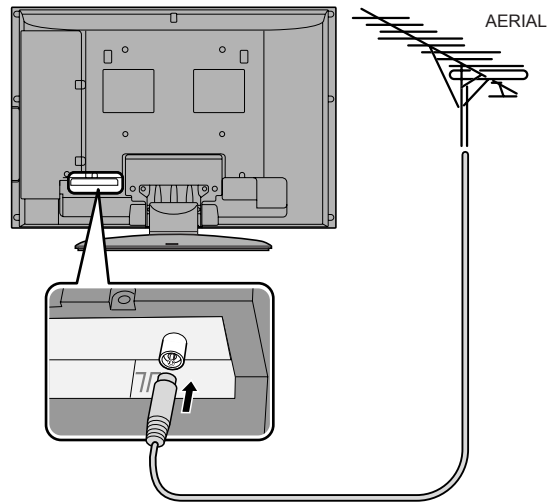

- After all the connections have been made, insert the plug into an AC outlet.

Care when setting

■ Power requirements

- Connect the power cord only to a 110-240V, 50/60Hz AC outlet.

■ When attaching the TV to the wall, use the optional JVC wall mounting unit

- Consult a qualified technician.
- See the included manual on mounting procedures.
- JVC assumes no responsibility for damage due to improper mounting.
- 200mm × 200mm mount which conforms to VESA standards.

■ Installation requirements

- To avoid overheating, ensure the unit has ample room.

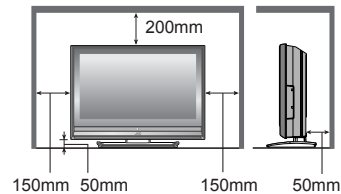

Connect a VCR / DVD recorder

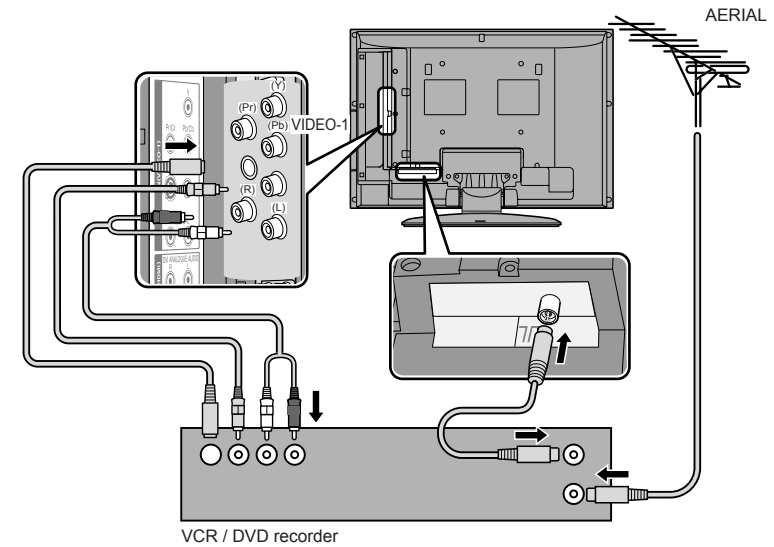

- After all the connections have been made, insert the plug into an AC outlet.
- If both composite and S-VIDEO cables are connected, S-VIDEO will be enable.

Tidying the cables

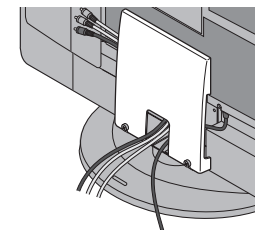

LT-Z37EX6

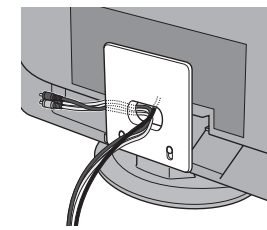

LT-Z32EX6 / LT-Z26EX6

- To remove the cable cover, refer to back of the cover.

ENGLISH

IMPORTANT!

PREPARE

USE

SETTINGS

TROUBLE?

Initial settings

Set the menu language, installation location and automatically register the TV channels. These channels can be edited later in "Editing channels" (P. 11).

ENGLISH

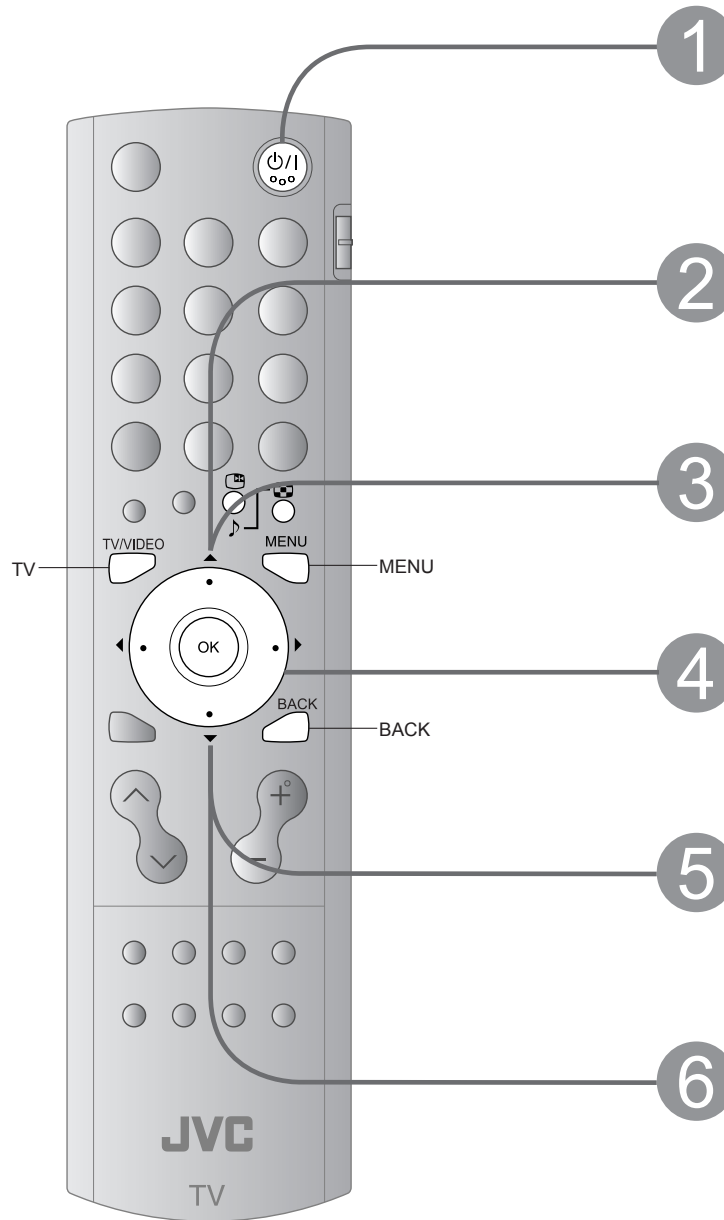

1 Begin

- Shown only when powering on for the first time.
- The power on the unit can also be used.

2 Select a language

① select
② set

3 Select the teletext language group

select

- For the teletext language group
➔ "Language group for teletext"
(P. 35)
- If the characters are unreadable.
➔ "Language group for teletext"
(P. 35)

4 Automatically register channels

5 Check what was registered

■ Edit channels
➔ ④ in "Editing channels" (P. 11)

6 Confirm

■ To the previous screen ➔

■ Exit ➔

■ If the "JVC" logo does not appear or if you wish to make changes later
➔ "Language", "Teletext language" and "Auto Program" (P. 28)

ENGLISH

IMPORTANT!

PREPARE

USE

SETTINGS

TROUBLE?

Editing channels

Edit the channels registered with "Auto Program" in "Initial settings" (P. 9).

ENGLISH



When coming from "Initial settings" (P. 9), skip to 4.

- 1 Display the menu bar
MENU
- 2 Select "Set Up"
Set Up
- 3 Select "Edit / Manual"
Edit/Manual
- 4 Select a row
PR AV ID CH/CC
- 5 Edit
- 6 Finish

- To the previous screen
BACK
- Exit
MENU

Move a channel's position

MOVE

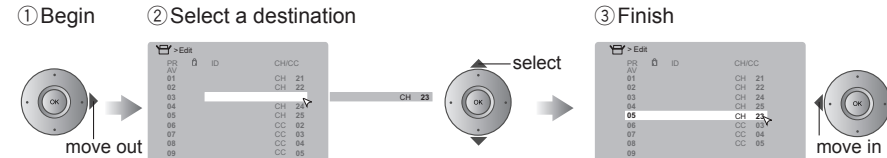

Edit a channel name

ID

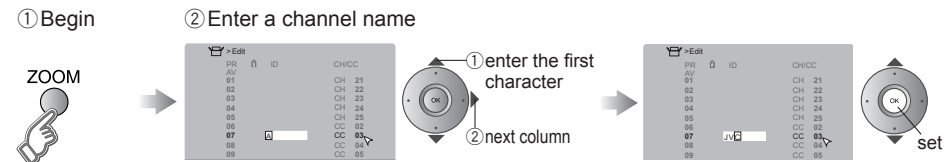

Insert a channel

INSERT

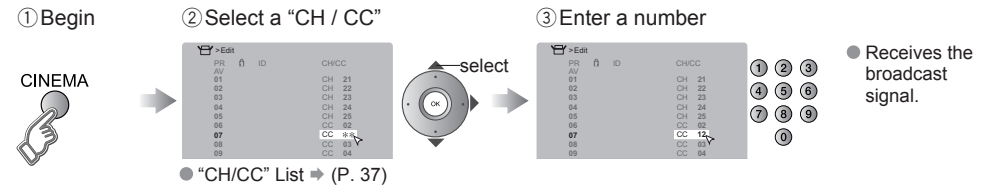

Delete a channel

DELETE



Register a new channel

MANUAL

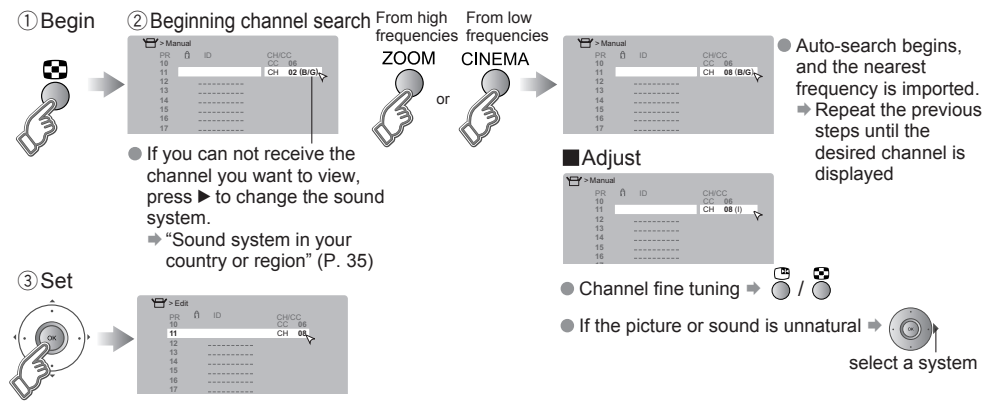

ENGLISH

IMPORTANT!

PREPARE

USE

SETTINGS

TROUBLE?

Connecting external devices

You can connect many different devices to the rear panel of the TV.
Please read the user manuals of each device before setting up.
(Connecting cables are not supplied with this TV.)

VCR / DVD / other devices

⇒ : signal direction

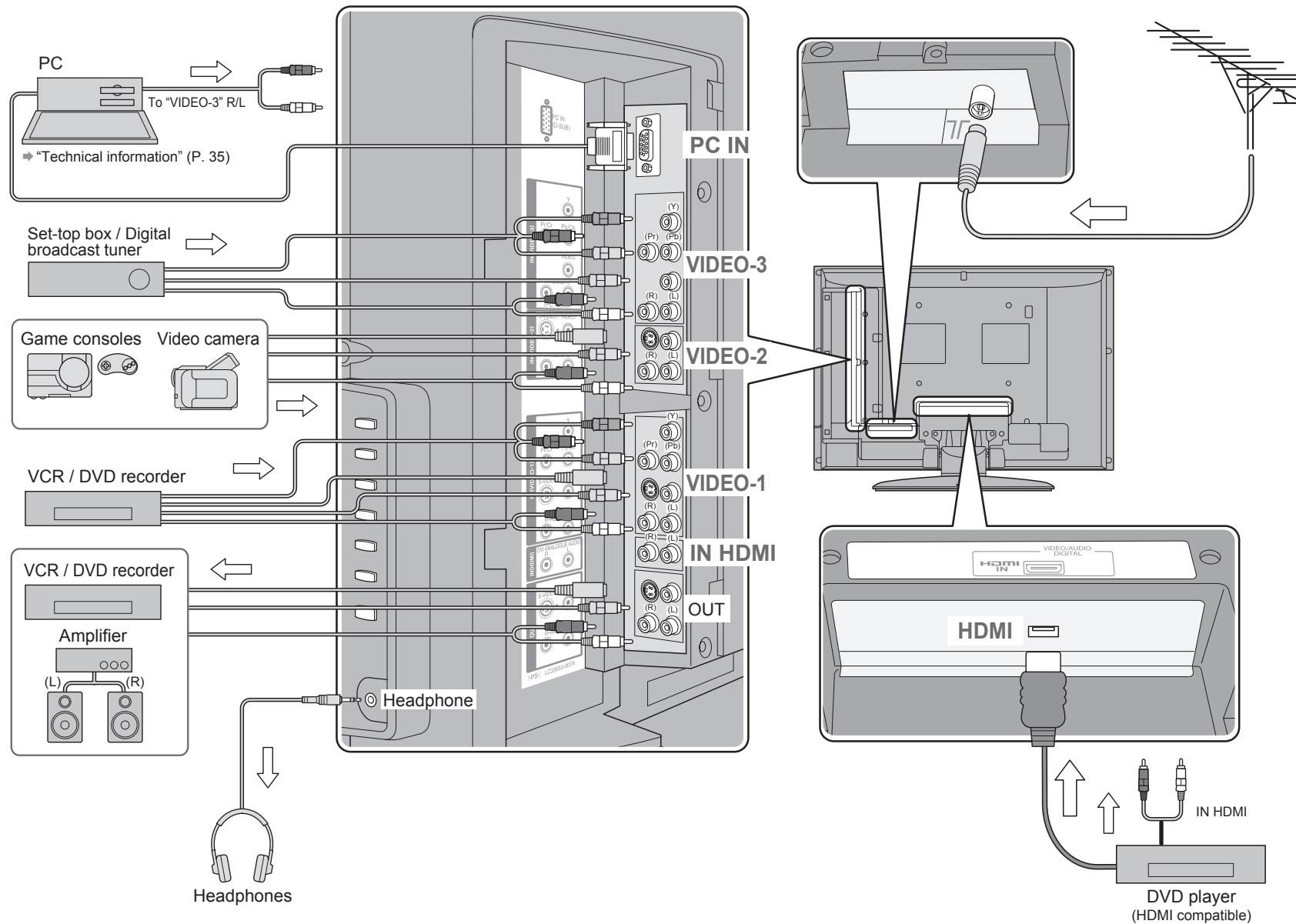

VIDEO-1 Watching videos

Output ↑	Input ↓
	· Composite signal / Component signal / S-VIDEO / Sound L / R

- Use Component signal
⇒ "Switch between video and component signal" (P. 22)
- Use S-VIDEO
⇒ "Using S-VIDEO" (P. 22)

VIDEO-2 Watching videos

Output ↑	Input ↓
	· Composite signal / S-VIDEO / Sound L / R

- Use S-VIDEO
⇒ "Using S-VIDEO" (P. 22)

VIDEO-3 Watching DVDs

Output ↑	Input ↓
	· Composite signal / Component signal / Sound L / R

- Use Component signal
⇒ "Switch between video and component signal" (P. 22)

HDMI Connecting HDMI devices

Output ↑	Input ↓
	· HDMI signal (P. 36)

- "HDMI Setting" ⇒ (P. 28)

OUT

Video and sound signal of a TV channel you are viewing outputs from this terminal

Output ↓
· Composite signal / S-VIDEO / Sound L / R

- "Using OUT terminal". ⇒ (P. 22)

- Connect a "DVI" device to "HDMI" ⇒ (P. 36)

Enjoying your new TV!

ENGLISH

ENGLISH

Watching TV

PAGE
17

- View channel information
- Change the aspect ratio
- Enjoy "Cinema Surround"
- Register your favourite channels

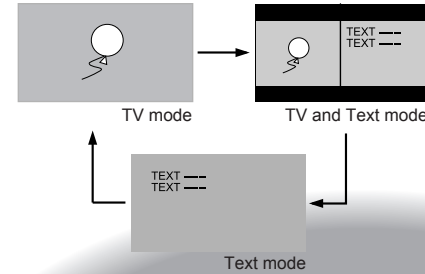
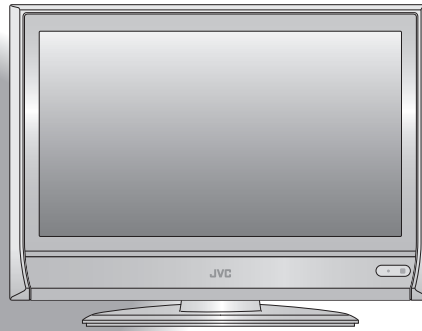
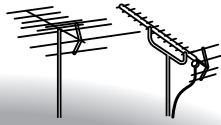
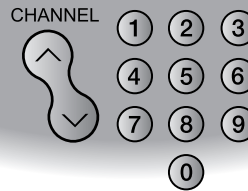

Viewing teletext

PAGE
19

- Enlarge the text
- To the index page
- Hold the current page
- Switch briefly between teletext and TV
- Bookmark your favourite pages
- Reveal hidden pages

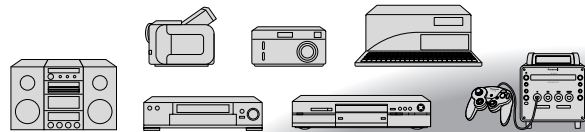

Watching videos / DVDs

PAGE
21

- Watch high quality video (S-VIDEO)
- Switch between video and component signal
- PC position adjustment

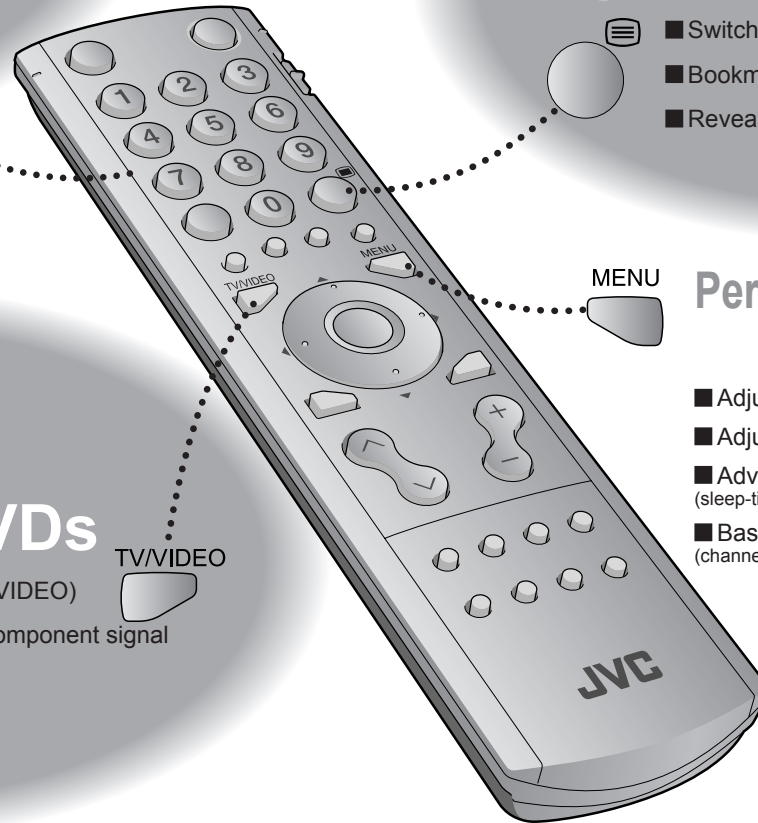

Personal preferences

PAGE
27

- Adjust the picture
- Adjust the sound
- Advanced settings (sleep-timer / channel guard, etc.)
- Basic settings (channel settings, etc.)

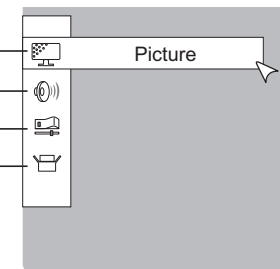

IMPORTANT!

PREPARE

USE

SETTINGS

TROUBLE?

Watching TV

ENGLISH

1 **Power on**
 The blue power lamp on the TV lights
 ● Press again to turn the screen off and put the TV into standby mode.

2 **Select a channel**
 E.g.
 1: 0 → 1
 15: 1 → 5
 ■ Move up or down a channel
 CHANNEL up
 CHANNEL down

■ Switch between mono / stereo / bilingual broadcasting
 → "Stereo / I-IT" (P. 28)

Note
 ● To completely turn off the TV, unplug the AC plug.

■ Mute

■ Volume

Basic operations using the side buttons

1 Power on

2 Change the channel

■ Volume

Channel information
DISPLAY

■ Select a page → select

PR List
 ● Channels registered in "Initial settings" will appear here.

Channel information
 (No indication)

select view

Change the aspect ratio
ZOOM

Zoom
 Auto
 Panoramic
 Regular
 14:9 Zoom
 16:9 Zoom
 16:9 Zoom Subtitle
 Full

1 select
 2 set

16:9 Zoom

Move the picture with ▲ or ▼ while this bar is displayed

- When set to "Auto", the aspect ratio will turn to the ratio obtained from the information the TV received. Without receiving aspect information, it will be the setting in "Auto" of "Zoom" (P. 30)
- Not available in 1080i (1125i) / 720p (750p) signals.
- In PC mode, "Regular" and "Full" can be selected.

Enjoy ambient sound
CINEMA SURROUND

Cinema Surround High

- High : For stereo sound
- Low : For stereo sound (when the sound distorts in "High" mode)
- Mono : For mono sound (emulates a stereo-like sound)
- Off : Turns off "Cinema Surround"

Always return to the channel you want to view
RETURN PLUS

■ Registered as return channel
 While the channel is displayed
 RETURN+ Hold down for 3 seconds

Return Plus Programmed!

■ Cancel
 While the channel is displayed
 RETURN+ Hold down for 3 seconds

Return Plus Canceled!

■ Recall the return channel → RETURN+

Return to the last channel you were viewing
RETURN

RETURN+

Current channel 23 ↔ Last channel 34

Viewing teletext

This TV can display TV broadcasts and teletext on the same channel in two windows.

ENGLISH

1 When watching TV

2 Enter a teletext page

3 Move up or down a page

4 View sub-pages

to sub-page

Bookmark your favourite page

1 Display your favourites list

2 Select a coloured button to save your page to

3 Enter the number of the page to save

4 Save

LIST MODE

MODE (RED) (GREEN) (YELLOW) (BLUE)

TO P MENU

■ Recall your favourite page → Press the coloured button as in step 2

Hold the current page

HOLD

■ Release → Press "HOLD" again

Reveal hidden pages

REVEAL

Display hidden information (answers to quizzes, etc.)

Enlarge the text

SIZE

Double the size of the displayed text

To the index page

INDEX

Returns to page "100" or a previously designated page

Switch briefly from teletext to TV

CANCEL

Leave the current page open, while you switch to watch TV

● Useful when running a page search.

ENGLISH

IMPORTANT!

PREPARE

USE

SETTINGS

TROUBLE?



Watching videos / DVDs

ENGLISH

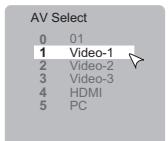
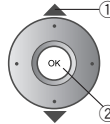

- Select the video source**
 →  →  (1) select
 (2) watch
- Operate the connected device and play a video**

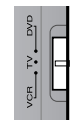

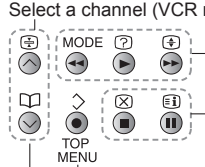
Operate JVC VCRs and other devices

-  DVD players
 VCRs and DVD recorders
-  Turn on the device
-  Select a channel (VCR mode)
 Rewind / Playback / Fast-forward
 Stop / Pause
 Record / Display DVD top menu
 Select a chapter (DVD mode)

● Some models of JVC devices cannot be operated with this remote control.

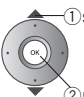
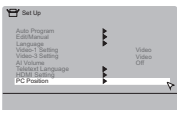
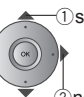

PC position adjustment

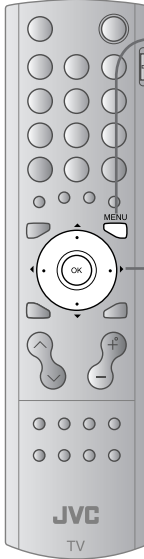

-  Display the menu bar
- Select "Set Up" →  (1) select
 (2) next →  → Select "PC Position" →  (1) select
 (2) next
 ● Shown only when "PC" is selected.
-  (1) adjust ● Reset position → 
 (2) set

Switch between video and component signal

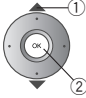

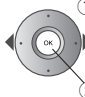
-  Display the menu bar
- Select "Set Up" →  (1) select
 (2) next
- Select "Video-1 Setting" or "Video-3 Setting" →  (1) select
- Change settings →  (1) select
 (2) set
 Video : For normal video signal
 Component : For component video signal

Using S-VIDEO

- If both composite and S-VIDEO cables are connected, S-VIDEO will be enable.

Using OUT terminal

- Component and PC signals does not output from this terminal.
- When you are viewing video signal, no signal will output through the S-VIDEO terminal.
- HDMI inputs does not output from this terminal.

ENGLISH

IMPORTANT!

PREPARE

USE

SETTINGS

TROUBLE?

Useful functions

ENGLISH

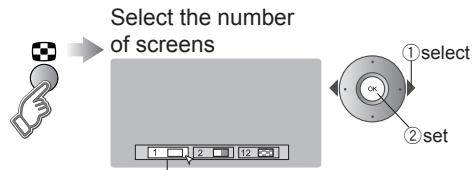

Select the number of screens

Selecting "1" returns to normal viewing mode
● Not available in PC mode.

■ Watch in dual-picture mode
E.g. You can watch TV and video at the same time.

(For wide aspect ratio signals)



● Switch between the sound sources
→ (Main)

● Change the channel
→ (Main)
→ (Sub)

Watch in multi-picture mode

MULTI-PICTURE

■ Select a channel in 12-screen mode
All registered channels are displayed as still images.

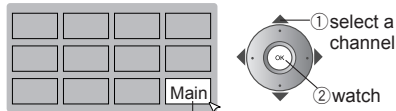

Only the selected frame has a moving picture.

● Move up or down a page
● Not available for HDMI input.

Take snapshots of the screen

FREEZE

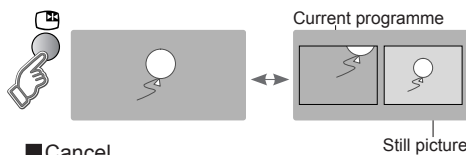

■ Cancel
→ Press "Freeze" again, or change the channel
● Not available when the SUB-PICTURE is displayed, or when in PC mode.
● You cannot save or export the snapshot.

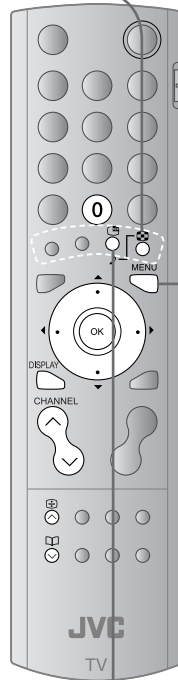

Set a time for the TV to turn itself off
SLEEP TIMER

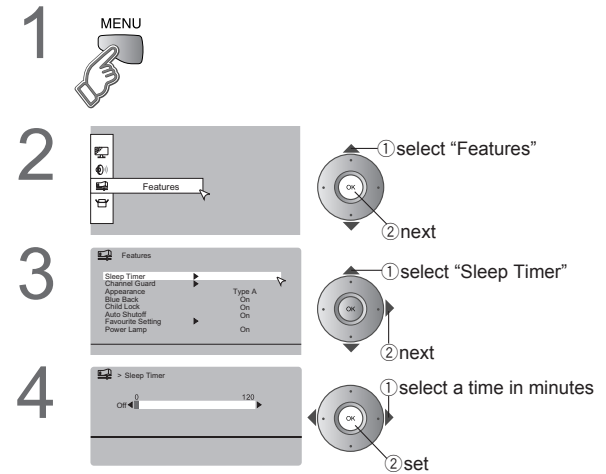

■ Cancel → Set the time to "0" in step 4
■ Remaining time → You can confirm the remaining time at step 4, after repeating this process.

● After steps 1 and 2 above

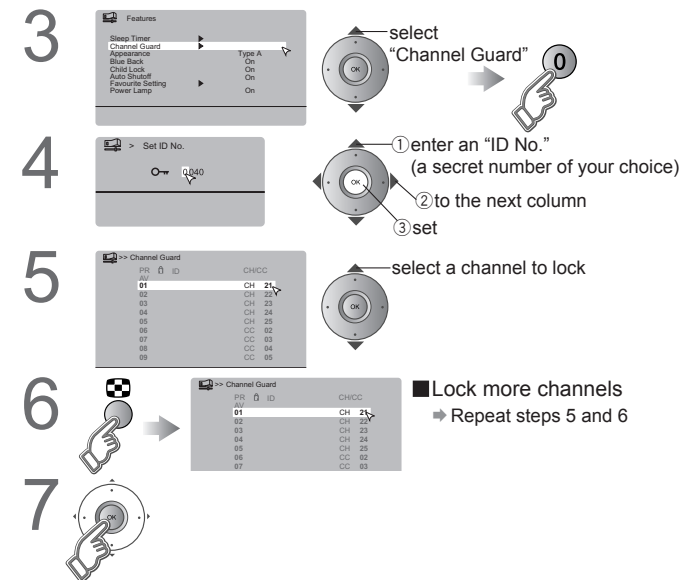

Stop children from watching specific channels
CHANNEL GUARD

■ Lock more channels
→ Repeat steps 5 and 6
■ Release a channel → Press "Freeze" again in step 6
■ View a locked channel → Use the numerical buttons to enter the channel number. When "ID" appears, press "Display" and enter your "ID No.". (If you forget your "ID No.", check it in step 4.)

ENGLISH

IMPORTANT!

PREPARE

USE

SETTINGS

TROUBLE?

Useful functions (continued)

ENGLISH

Register a channel to a button FAVOURITE CHANNEL

- 1 While the channel is displayed
Hold down for 3 seconds
- 2 Press the number to register it on

Disappears after a few seconds

Recall the favourite channel

- 1
- 2 Press the number you registered

● Customisations (P. 28) to the picture of a favourite channel get saved as well.

Check your favourite channels

→ Press and confirm that the channels you have registered have a beside them

Delete a favourite channel

- 1 → "MENU" → → "Features" → "Favourite Setting"

select
- 2 delete

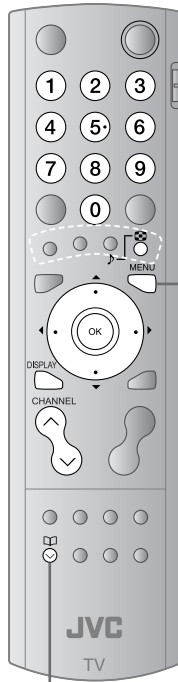

Displays a blue screen and mute the sound when the signal is weak

BLUE BACK

→ "MENU" → → "Features" → "Blue Back"

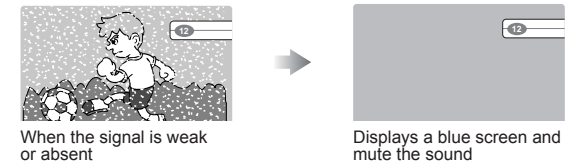
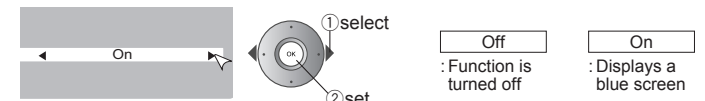

Set the power to turn off if no signal is received and no operation is performed

AUTO SHUTOFF

→ "MENU" → → "Features" → "Auto Shutoff"

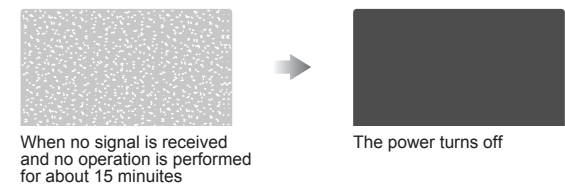
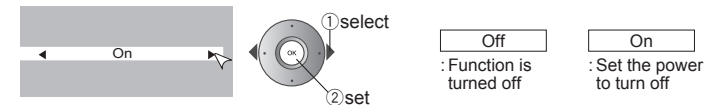

Prevent sudden increase or decrease of sound when changing channels

AI VOLUME

→ "MENU" → → "Set Up" → "AI Volume"

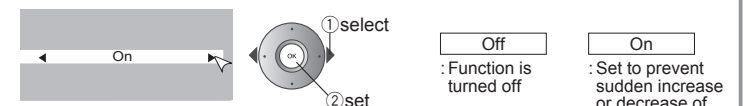

ENGLISH

IMPORTANT!

PREPARE

USE

SETTINGS

TROUBLE?

Customising your TV

ENGLISH



- 1 Display the menu bar**
Press the MENU button.
- 2 Select a menu**
Use the directional buttons to select a menu item (Picture, Sound, Features, Set Up) and press OK.
- 3 Select an item**
Use the directional buttons to select an item within the menu and press OK.
- 4 Adjust / Configure**
Use the directional buttons to adjust or select a value and press OK.

■ To the previous screen
 → BACK

■ Exit MENU
 → MENU

● The menu disappears after one minute of inactivity.

■ When adjusting with the sliding-bar
 Move →

■ When selecting from presets
 ◀ Standard ▶
 The item will change.

● Some items have a sub-menu.

Menu	Item	Adjustments / Configurations	
Picture	Picture Mode	Picture mode (Bright / Standard / Soft)	
	Back Light	Backlight brightness (Darker ⇔ Brighter)	
	Contrast	Contrast (Lower ⇔ Higher)	
	Bright	Brightness (Darker ⇔ Brighter)	
	Sharp	Sharpness (Softer ⇔ Sharper)	
	Colour	Colour (Lighter ⇔ Deeper)	
	Tint	Tint (Reddish ⇔ Greenish) Only NTSC	
	White Balance	Colour temperature (Warm / Mid / Cool)	
	Features	Finer picture adjustments (P. 29)	
	Sound	Stereo / I · II	Mode / Language (O : MONO / ∞ : STEREO / I : SUB1 / II : SUB2 / MONO) (P. 36)
Bass		Low tones (Weaker ⇔ Stronger)	
Treble		High tones (Weaker ⇔ Stronger)	
Balance		Speaker balance (Left Stronger ⇔ Right Stronger)	
Cinema Surround		Ambience level (High / Low / Mono / Off)	
Tone Correction		Make the sound more clear (On / Off)	
Features	Sleep Timer	Timer for turning off the TV (P. 24)	
	Channel Guard	Stops children from watching specific channels (P. 24)	
	Appearance	Format for displaying the channel number and menu screen. (Type A / Type B)	
	Blue Back	Displays a blue screen and mute the sound when the signal is weak or absent (P. 26)	
	Child Lock	Disables the front control buttons of the TV	
	Auto Shutoff	Set the power to turn off if no signal is received and no operation is performed for about 15 minutes. (P. 26)	
	Favourite Setting	Clear favourite channel settings (P. 25)	
	Power Lamp	Lights power lamp (P. 5) while the TV is on (On / Off)	
	Set Up	Auto Program	Automatically registers channels (P. 10, ④)
		Edit / Manual	Change registered channels or add new ones (P. 11)
Language		Select a language for on-screen menus (P. 10, ②)	
Video-1 Setting		For use with video players and other devices (P. 22)	
Video-3 Setting		For use with video players and other devices (P. 22)	
AI Volume		Prevent sudden increase or decrease of sound when changing channels (P. 26)	
Teletext Language	Select a language for Teletext programmes (P. 10, ③)		
HDMI Setting	HDMI : Size (1 / 2 / Auto) Audio (Digital / Analogue / Auto)		
PC Position	PC position adjustment (P. 21)		

- Other settings · Change the aspect ratio → "ZOOM" (P. 17)
- Turn on "Cinema Surround" → "CINEMA SURROUND" (P. 17)

Advanced picture adjustment

By default, the TV automatically adjusts itself for the best picture.

ENGLISH

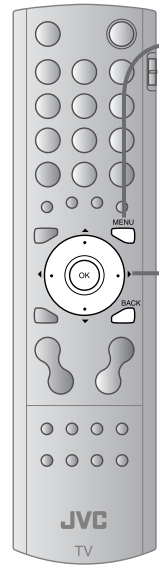

1 Display the menu bar



2 Select "Picture"

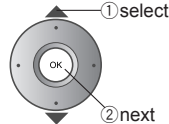
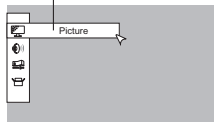

3 Select "Features"

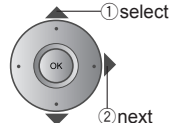

4 Select an item

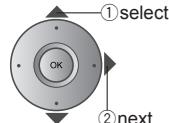

E.g. "Super DigiPure"

5 Change settings

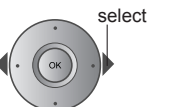

E.g. "Super DigiPure"

6 Finish

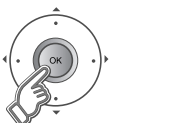

■ To the previous screen



■ Exit



● The menu disappears after one minute of inactivity.

Super DigiPure	For natural-looking outlines		<input type="checkbox"/> Off : Function is turned off	<input type="checkbox"/> Min : When the picture loses sharpness	<input type="checkbox"/> Max : When noise appears	<input type="checkbox"/> Auto : Automatically adjusts
Pull Down	For smooth cinema film		<input type="checkbox"/> Off : Function is turned off	<input type="checkbox"/> On : Function is always on	<input type="checkbox"/> Auto : Automatically adjusts	
Colour Management	For natural-looking pictures		<input type="checkbox"/> Off : Function is turned off	<input type="checkbox"/> On : Maintain a natural colour balance		
Picture Management	Fix bright / dark pictures		<input type="checkbox"/> Off : Function is turned off	<input type="checkbox"/> On : Make it easier to view bright / dark pictures		
Smart Picture	Fix brightness of white areas		<input type="checkbox"/> Off : Function is turned off	<input type="checkbox"/> On : Make it easier to view white areas ● Not available when "Picture Mode" is set to "Bright" (P. 28).		
MPEG Noise Reduction	To reduce MPEG video noise		<input type="checkbox"/> Off : Function is turned off	<input type="checkbox"/> On : When noise appears		
Colour System	When there is no colour		① Select the screen to change settings on <input type="checkbox"/> Main : Main picture <input type="checkbox"/> Sub : Sub-picture in MULTI-PICTURE mode (P. 23)			
			② Select the colour system <input type="checkbox"/> PAL <input type="checkbox"/> SECAM <input type="checkbox"/> NTSC 3.58 <input type="checkbox"/> NTSC 4.43 <input type="checkbox"/> Auto ● For colour system in your country or region. ➔ "Colour system in your country or region" (P. 35)			
Zoom	Change the aspect ratio		Select a default aspect ratio for Auto in "Zoom" (P. 17) <input type="checkbox"/> Panoramic <input type="checkbox"/> Regular <input type="checkbox"/> 14:9 Zoom 16 : 9 4 : 3 14 : 9			

ENGLISH

IMPORTANT!

PREPARE

USE

SETTINGS

TROUBLE?

Troubleshooting

ENGLISH

Severe noise or snow



- Is the TV connected correctly to the aerial?
- Change the direction of the aerial.
- Is the aerial or its cable damaged?
 - ➔ Consult your retailer

Patterns, stripes or noise



- Is the aerial receiving interference from high-voltage power lines or wireless transmitters?
 - ➔ Consult your retailer
- Are connected devices too close to the TV?
 - ➔ Insert the minimum distance between the aerial and the cause of interference until no interference

Ghosting

(Doubling of images)



- Are you receiving interference from signals reflected off mountains or buildings?
 - ➔ Adjust the direction of your aerial, or change to a good-quality directional aerial

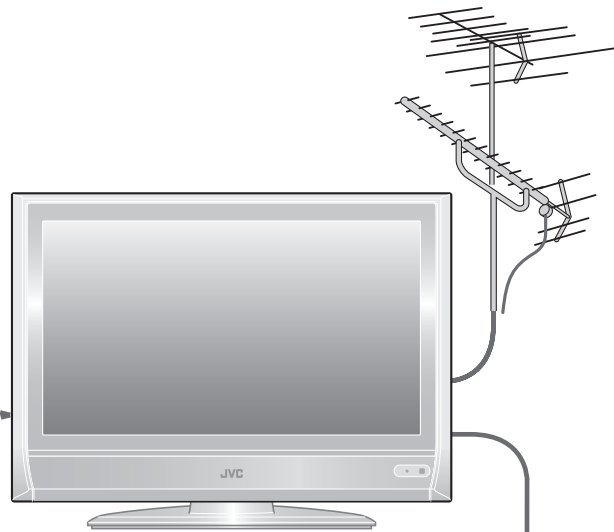

I can't turn it on!

- Is the power cord connected to the AC outlet correctly?

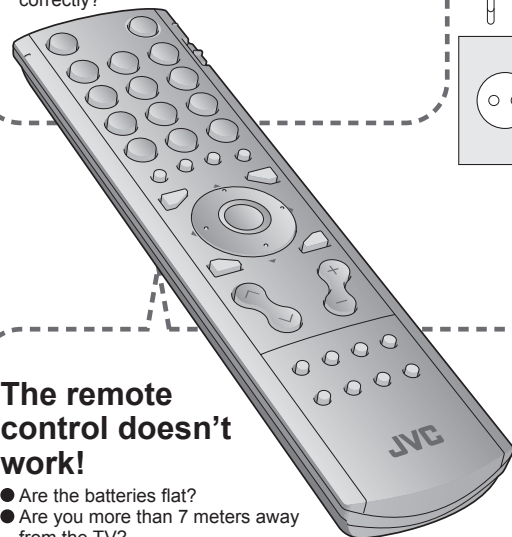

The remote control doesn't work!

- Are the batteries flat?
- Are you more than 7 meters away from the TV?
- Is the "MODE (VCR / TV / DVD)" set to "TV"?
- When viewing teletext, the TV menu bar does not appear.
- Depending on the stability of the signal, there may be a time lag when changing channels.

	Problem	Actions	page
Basics	Remote control stops working	<ul style="list-style-type: none"> ● Unplug TV, several minutes later plug it in again. 	-
	Front control buttons does not work	<ul style="list-style-type: none"> ● Switch "Child Lock" to "Off". 	28
Screen	Aspect ratio changes unintentionally	<ul style="list-style-type: none"> ● Press "ZOOM" to return to your settings. 	17
	PC screen alignment is off	<ul style="list-style-type: none"> ● Adjust the "PC position". 	21
Picture	Poor picture quality	<ul style="list-style-type: none"> ● Unnatural colour >>> Adjust "Colour" and "Back Light". Check your "Colour System". If "Auto" is selected, select the specific colour system manually. ● Noise >>> Set to the following functions. <ul style="list-style-type: none"> Picture Mode : Standard Super DigiPure : Max ● Dull picture >>> Set to the following functions. <ul style="list-style-type: none"> Picture Mode : Bright Super DigiPure : Min 	28 30 28 30
	Strange picture when using an external device	<ul style="list-style-type: none"> ● If the top of the image is distorted, check the video signal quality itself. ● If movement appears unnatural when receiving a signal from a DVD player, etc. with 625p (progressive-scanning), change the output setting of the external device to 625i (interlace-scanning). 	- -
	Blue screen appears on the screen	<ul style="list-style-type: none"> ● Switch "Blue Back" to "Off". 	26

ENGLISH

IMPORTANT!

PREPARE

USE

SETTINGS

TROUBLE?

Troubleshooting (continued)

	Problem	Actions	page
ENGLISH	Sound	<ul style="list-style-type: none"> ● Adjust the "Bass" and "Treble". ● If receiving a poor signal in "Stereo / I-II", switch to "Mono". ● Adjust the channel reception using "Manual". 	28
			28
HDMI	Wrong screen size	<ul style="list-style-type: none"> ● Switch "Size" in "HDMI Setting" to "1" or "2". 	28
	No picture, no sound	<ul style="list-style-type: none"> ● Use the cable marked with HDMI logo. HDMI 	-
	No sound	<ul style="list-style-type: none"> ● Check if the device is compliant with HDMI. ● Switch "Audio" in "HDMI Setting" to "Digital" or "Auto" for HDMI devices, or "Analogue" or "Auto" for DVI devices. 	- 28
	Green and distorted screen	<ul style="list-style-type: none"> ● Wait a little for the signal to stabilize when switching the signal format for an "HDMI" device. 	-
	Some functions do not work	<ul style="list-style-type: none"> ● It is not a malfunction. Some functions (dark background) in the menu do not work depending on the situation. 	-
	Some inputs cannot be selected in the sub-picture	<ul style="list-style-type: none"> ● "VIDEO-1 (Component signal)", "VIDEO-3 (Component signal)", "HDMI" inputs and PC mode cannot be selected in the sub-picture. 	-
FUNCTIONS			

	Problem	Actions	page
ENGLISH	Screen	<ul style="list-style-type: none"> ● LCD panels use fine dots ("pixels") to display images. While more than 99.99% of these pixels function properly, a very small number of pixels may not light, or may light all the time. Please understand that this is not a malfunction. 	-
IMPORTANT!	OUT terminal	<ul style="list-style-type: none"> ● Some inputs does not output from OUT terminal 	22

Technical information

ENGLISH

Language group for teletext

Group	Languages
Group-1	Turkish, Hungarian, English, German, French, Italian, Spanish, Portuguese, Greek, Swedish, Finnish
Group-2	Polish, Serbian, Croatian, Slovenian, Czech, Slovak, Rumanian, Hungarian, German, French, Italian, Swedish, Finnish
Group-3	Russian, Bulgarian, Lettish, Lithuanian, Estonian, Ukrainian, Serbian, Croatian, Slovenian, Czech, Slovak, English, German
Group-4	Arabic, Czech, Slovak, Hungarian, English, German, French, Italian, Spanish, Portuguese, Swedish, Finnish
Group-5	Farsi, Czech, Slovak, Hungarian, English, German, French, Italian, Spanish, Portuguese, Swedish, Finnish

- If the characters are unreadable. ➔ Select different teletext language group.

Colour system in your country or region

Area	Country or Region	System
Asia, Middle East	Bahrain, Kuwait, Oman, Qatar, United Arab Emirates, Yemen, etc. Indonesia, Malaysia, Singapore, Thailand, India, etc.	PAL
	China, Vietnam, etc.	
	Hong Kong, etc.	
	Islamic Republic of Iran, Lebanon, Saudi Arabia, etc.	SECAM
	Philippines, Taiwan, Myanmar, etc.	NTSC
Europe	Russia, etc.	SECAM
	Czech Republic, Poland, etc.	PAL
	Germany, Holland, Belgium, etc.	
	UK, etc.	
Oceania	Australia, New Zealand, etc.	PAL
Africa	Republic of South Africa, etc.	PAL
	Nigeria, etc.	
	Egypt, Morocco, etc.	SECAM

Sound system in your country or region

Area	Country or Region	System
Asia, Middle East	Bahrain, Kuwait, Oman, Qatar, United Arab Emirates, Yemen, etc. Indonesia, Malaysia, Singapore, Thailand, India, etc.	B/G
	China, Vietnam, etc.	D/K
	Hong Kong, etc.	I
	Islamic Republic of Iran, Lebanon, Saudi Arabia, etc.	B/G
	Philippines, Taiwan, Myanmar, etc.	M
Europe	Russia, etc.	D/K
	Czech Republic, Poland, etc.	
	Germany, Holland, Belgium, etc.	B/G
	UK, etc.	I
Oceania	Australia, New Zealand, etc.	B/G
Africa	Republic of South Africa, etc.	I
	Nigeria, etc.	
	Egypt, Morocco, etc.	B/G

Monoaural sound

Use this function when stereo sound or bilingual sound is hard to hear.

- Set "Stereo / I · II" to "MONO" ➔ (P. 28)

PC Signals that can be displayed

Macintosh computers are not supported. (Macintosh is a registered trademark of Apple Computer, Inc.)

Resolution	640 x 480 (VGA)	1024 x 768 (XGA)
Vertical frequency (Hz)	60.0	60.0

- If the signal doesn't appear, check that the vertical frequency on the PC is set to "60Hz".

Connect "DVI" devices

Connect a "DVI" device to "HDMI" using "DVI-HDMI" conversion cable. Connect analogue sound output of the DVI device to L and R terminals in IN HDMI.

- Set "Audio" in "HDMI Setting" to "Analogue" or "Auto" ➔ (P. 28)

ENGLISH

IMPORTANT!

PREPARE

USE

SETTINGS

TROUBLE?

“CH/CC” List

To use the INSERT function (P. 11), find the “CH/CC” number corresponding to the TV’s Channel number from this table.

US: The US channel numbers are the channel numbers used in the United States, Philippines, etc.
 CCIR: The CCIR channel numbers are the channel numbers used in the Middle East, Southeast Asia, etc.
 OIRT: The OIRT channel numbers are the channel numbers used in Eastern Europe, Russia, Vietnam, etc.
 AUSTRALIA: The AUSTRALIA channel numbers are the channel numbers used in Australia, etc.

CH	Channel					CC	Channel				
	US	CCIR	OIRT	AUSTRALIA	US		CCIR	OIRT	AUSTRALIA		
CH 02	US-02	E2	R1	AU-0	CC 01	S-1			AU-5		
CH 03	US-03	E3		AU-1	CC 02	S-2					
CH 04	US-04	E4	R2	AU-2	CC 03	S-3					
CH 05	US-05	E5	R6	AU-6	CC 04	S-4					
CH 06	US-06	E6	R7	AU-7	CC 05	S-5					
CH 07	US-07	E7	R8	AU-8	CC 06	S-6			AU-5A		
CH 08	US-08	E8	R9	AU-9	CC 07	S-7					
CH 09	US-09	E9			CC 08	S-8					
CH 10	US-10	E10	R10	AU-10	CC 09	S-9					
CH 11	US-11	E11	R11	AU-11	CC 10	S-10					
CH 12	US-12	E12	R12		CC 11	S-11					
CH 13	US-13				CC 12	S-12					
CH 14	US-14, W+29				CC 13	S-13					
CH 15	US-15, W+30				CC 14	A S-14					
CH 16	US-16, W+31				CC 15	B S-15					
CH 17	US-17, W+32				CC 16	C S-16					
CH 18	US-18, W+33				CC 17	D S-17					
CH 19	US-19, W+34				CC 18	E S-18					
CH 20	US-20, W+35				CC 19	F S-19					
CH 21	US-21, W+36	E21			CC 20	G S-20					
CH 22	US-22, W+37	E22			CC 21	H S-21					
CH 23	US-23, W+38	E23			CC 22	I S-22					
CH 24	US-24, W+39	E24			CC 23	J S-23					
CH 25	US-25, W+40	E25			CC 24	K S-24					
CH 26	US-26, W+41	E26			CC 25	L S-25					
CH 27	US-27, W+42	E27			CC 26	M S-26					
CH 28	US-28, W+43	E28			CC 27	N S-27					
CH 29	US-29, W+44	E29			CC 28	O S-28					
CH 30	US-30, W+45	E30			CC 29	P S-29					
CH 31	US-31, W+46	E31			CC 30	Q S-30					
CH 32	US-32, W+47	E32			CC 31	R S-31					
CH 33	US-33, W+48	E33			CC 32	S S-32					
CH 34	US-34, W+49	E34			CC 33	T S-33					
CH 35	US-35, W+50	E35			CC 34	U S-34					
CH 36	US-36, W+51	E36			CC 35	V S-35					
CH 37	US-37, W+52	E37			CC 36	W S-36					
CH 38	US-38, W+53	E38			CC 37	W+1 S-37					
CH 39	US-39, W+54	E39			CC 38	W+2 S-38					
CH 40	US-40, W+55	E40			CC 39	W+3 S-39					
CH 41	US-41, W+56	E41			CC 40	W+4 S-40					
CH 42	US-42, W+57	E42			CC 41	W+5 S-41					
CH 43	US-43, W+58	E43			CC 42	W+6					
CH 44	US-44, W+59	E44			CC 43	W+7					
CH 45	US-45, W+60	E45			CC 44	W+8					
CH 46	US-46, W+61	E46			CC 45	W+9					
CH 47	US-47, W+62	E47			CC 46	W+10					
CH 48	US-48, W+63	E48			CC 47	W+11					
CH 49	US-49, W+64	E49			CC 48	W+12					
CH 50	US-50, W+65	E50			CC 49	W+13					
CH 51	US-51, W+66	E51			CC 50	W+14					
CH 52	US-52, W+67	E52			CC 51	W+15					
CH 53	US-53, W+68	E53			CC 52	W+16					
CH 54	US-54, W+69	E54			CC 53	W+17					
CH 55	US-55, W+70	E55			CC 54	W+18					
CH 56	US-56, W+71	E56			CC 55	W+19					
CH 57	US-57, W+72	E57			CC 56	W+20					
CH 58	US-58, W+73	E58			CC 57	W+21					
CH 59	US-59, W+74	E59			CC 58	W+22					
CH 60	US-60, W+75	E60			CC 59	W+23					
CH 61	US-61, W+76	E61			CC 60	W+24					
CH 62	US-62, W+77	E62			CC 61	W+25					
CH 63	US-63, W+78	E63			CC 62	W+26					
CH 64	US-64, W+79	E64			CC 63	W+27					
CH 65	US-65, W+80	E65			CC 64	W+28					
CH 66	US-66, W+81	E66			CC 75		X				
CH 67	US-67, W+82	E67			CC 76		Y	R3			
CH 68	US-68, W+83	E68			CC 77		Z	R4	AU-3		
CH 69	US-69, W+84	E69			CC 78		Z+1	R5			
					CC 79		Z+2		AU-4		
					CC 95	A-5					
					CC 96	A-4					
					CC 97	A-3					
					CC 98	A-2					
					CC 99	A-1					

Specifications

Main unit

Model	LT-Z37EX6	LT-Z32EX6	LT-Z26EX6
Broadcasting systems	B / G / I / D / K / K1 / M (See “Technical information”, P. 35)		
Colour systems	PAL, SECAM, NTSC 3.58/4.43MHz		
Channels and frequencies	VHF low channel (VL) = 46.25 to 140.25 MHz VHF high channel (VH) = 147.25 to 423.25 MHz UHF channel (U) = 431.25 to 863.25 MHz · Receives cable channels in mid band (X to Z+2, S1 to S10), super band (S11 to S20) and hyper band (S21 to S41).		
Sound-multiplex systems	NICAM (I / B / G / D / K), A2 (B / G / D / K)		
Teletext systems	FLOF (Fastext), WST (standard system)		
Power requirements	AC 110 V - 240 V, 50/60Hz		
Audio output (Rated power output)	10 W + 10 W		
Speakers	(16 cm x 4 cm) oblique x 4	(15 cm x 5.5 cm) oblique x 2	(12 cm x 5 cm) oblique x 2
Power consumption [standby]	163 W [0.5 W]	120 W [0.5 W]	113 W [0.5 W]
Screen size (visible area size measured diagonally)	94 cm	81 cm	66 cm
Dimensions (W x H x D: mm) [without stand]	919 x 651.9 x 312 [919 x 603.7 x 128]	800 x 588.8 x 267.8 [800 x 545 x 137.7]	672 x 518.5 x 244 [672 x 471 x 137.7]
Weights [without stand]	21 kg [18.4 kg]	17 kg [15 kg]	14 kg [12 kg]
Accessories	(See “Check accessories”, P. 5)		

Terminals / Connectors

Terminal name	Terminal type	Signal type (IN)	Signal type (OUT)	Notes
Input terminals	VIDEO-1	RCA connectors x 6 S-VIDEO connector x 1	Composite video, S-video, Analogue component (576i (625i) / 480i (525i), Progressive : 576p (625p) / 480p (525p), HD : 1080i (1125i), 720p (750p) AUDIO L / R	
	VIDEO-2	RCA connectors x 3 S-VIDEO connector x 1	Composite video, S-video, AUDIO L / R	
	VIDEO-3	RCA connectors x 6	Composite video, Analogue component (576i (625i) / 480i (525i), Progressive : 576p (625p) / 480p (525p), HD : 1080i (1125i), 720p (750p) AUDIO L / R	
	HDMI	HDMI connector x 1	HDMI (576i (625i) / 480i (525i) / 576p (625p) / 480p (525p), 1080i (1125i), 720p (750p))	
	IN HDMI	RCA connectors x 2	AUDIO L / R	
Output terminals	PC INPUT	D-SUB (15 pins) x 1	Analogue PC signal (P. 36)	
	MONITOR OUT	RCA connectors x 3 S-VIDEO connector x 1	Composite video, S-video, Audio L / R	
	Headphone	Stereo mini-jack x 1 (3.5 mm in diameter)	Headphone output	

● We may change the design and specifications without notice.